

STANLEY®

MECHANICS TOOLS 2019 Middle East



STANLEY®

MECHANIC TOOLS SOLUTIONS THAT OUTPERFORM YOUR NEEDS & EXPECTATIONS

For 170 years, **STANLEY®** has been flexing its tool manufacturing muscles by continuously enhancing and enlarging its already massive collection of high-quality tool solutions.

With the introduction of new **STANLEY® AUTOMOTIVE** products, the company is offering industry-proven tools that are designed specifically for the needs of mechanics. These include roller cabinets and storage solutions for garages and a wide variety of tools such as ratchets, sockets, wrenches and accessories in many styles, sizes and finishes.

With over 170 years of experience in the industry, **STANLEY®** is renowned for designing, developing and making good quality tools. At the **STANLEY®** lab, every product undergoes stringent tests in order to maintain the brand's consistent quality and excellent performance standards.



TESTING & QUALITY CONTROL

Every **STANLEY® AUTOMOTIVE** tool is manufactured to exact specifications. As our extensive test procedures prove, we take quality very seriously. State-of-the-art test facilities ensure that every tool meets critical industry standards.



PROVEN TORQUE SUSTAINABLE

STANLEY® mechanics tools are designed and produced with highest standard, and have been through numerous torque tests, making sure their torque ability exceeds ASME standard, ensuring safety and durability!

ULTIMATE TORQUE exceeding **1.5X** of ANSI proof torque requirement

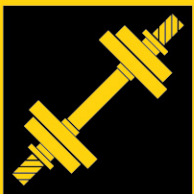

PROVEN TO BE TOUGH

To protect your safety while using, **STANLEY®** made strict standards for all our mechanics products. Since uneven hardness tends to cause accidents, individual components are placed under a hardness testing machine to ensure the materials meet strict requirements.

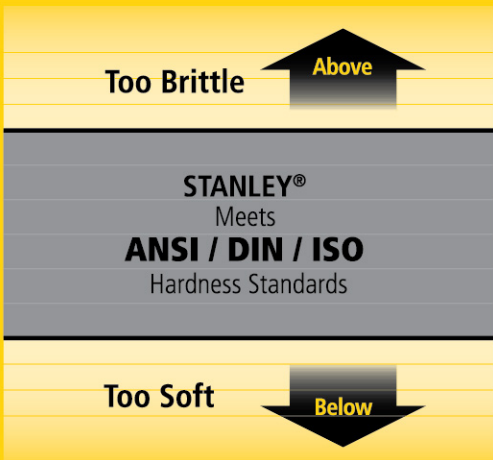

PROVEN TO BE STURDY

Every tool is drop-tested from various heights and angles, ensuring that they meet the industry's shock-resistance standards.



PROVEN TO WITHSTAND EXPOSURE TO SOLVENT

Solid tools are made for tough jobs. All **STANLEY®** tools are tested to resist corrosion caused by most oils and acids that are frequently used on the job.



PROVEN TO DEFY HUMIDITY

It does not matter if you work in humid conditions as our tools are tested to meet high rust-proofing standards. All **STANLEY®** mechanics tools are tested for 48 hours to verify that no excess amounts of corrosion is formed.

WRENCH NICKEL / CHROMIUM TEST

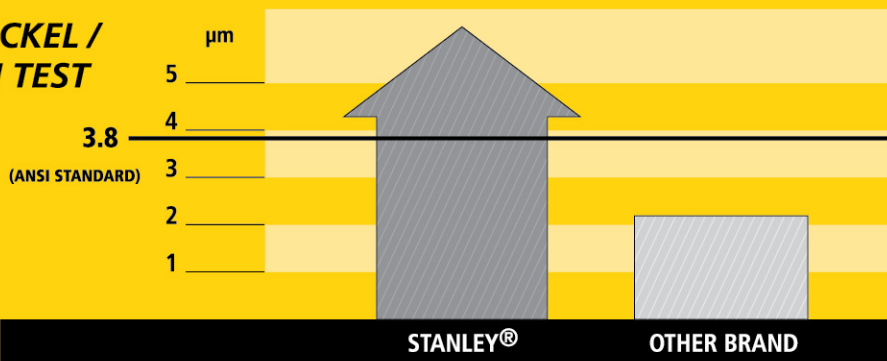

Better performance than other brand

CAPABLE TO WITHSTAND EXTREME CONDITIONS

All **STANLEY**® tools are carefully tested to conquer severe temperature changes. Be it intense heat or freezing conditions, our tools perform just as precisely and accurately as they do in conventional situations.

Temperature range

-20°C (-4°F) ~ 50°C (122°F)

tested for durability

REFINED FINISHING QUALITY

From ergonomically designed curves to carefully selected materials, all the finishing details are tested with simulated skin textures to ensure top quality products.



All **STANLEY**® ratchets, sockets and wrenches are manufactured globally and meet and exceed both **STANLEY**® and global specifications.

MANUFACTURING

Our manufacturing expertise has been honed over generations allowing us to provide the quality and performance and value that our customers demand. Hot and cold forging facilities ensure that we have complete control over materials quality - from the inside out. Our own factories annually produce hundred million sockets, ratchets, and wrenches.

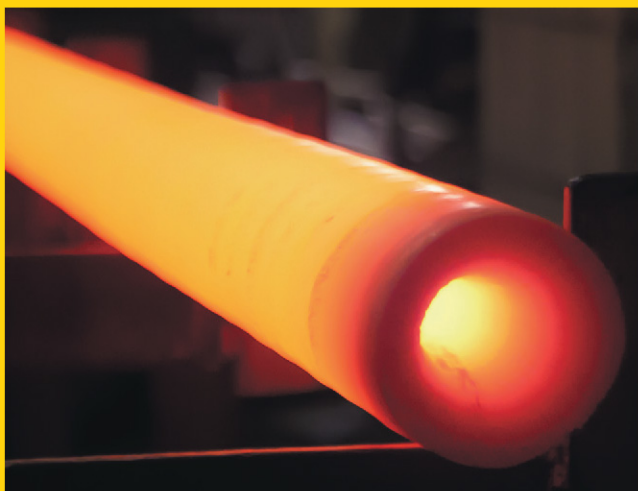

RESEARCH & DESIGN

Like all our products, **STANLEY**® tools are the result of original thinking combined with real users' input. We believe that true innovation is born out of this collaboration and that it is the best way to provide everything users demand for.



In any automotive workshop, diagnoses and repairs needs to be carried out quickly and efficiently. **STANLEY**® tools include advanced product features and innovative tool formats that offer professional users real choices in the workshop. Whether the task is a simple component replacement or a complex disassembly and repair job, this built-in versatility encourages a smooth and effective workflow.

SERVICE & SUPPORT

As you would expect, the **STANLEY**® tool range comes with the knowledge and support of a global tool supplier. We understand that our success is heavily dependent on yours, hence why our close partnership with distributors and suppliers is very important to us. Along with our distribution network, we can and will remain dedicated to the maintenance and development of this tool range, providing the very best solutions for our customers.

PRACTICAL & INNOVATIVE PACKAGING

Being a product from a global leader of professional hand tools, the **STANLEY**® range uses the very latest packaging technology to ensure that end users and distributors have a wide array of buying options. Designed for durability, the new packaging options are more efficient in material usage than ever before. This equates to more recyclable materials and less waste. They are also attractive, space efficient and command a strong in-store presence.

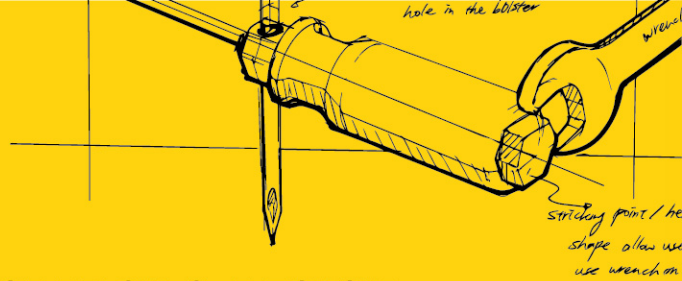

METAL STORAGE



7 DRAWERS ROLLER CABINET



COMPATIBLE with
**TRANS
MODULE**
system

- Multiple drawer sizes for flexible storage options
- Perforated side panels for vertical storage
- Ball bearing slides for smooth and heavy loading drawer operation
- Lockable castors
- PVC bumpers on corners
- Lockable drawers

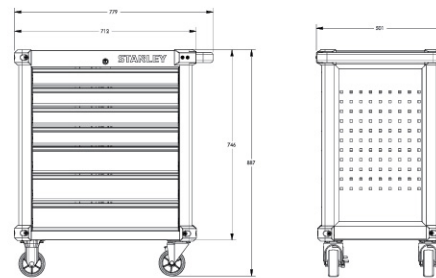

SKU #	Description	Overall Dimension (Length x Width x Height mm)	Effective Drawer Dimension (mm)	Total Load Capacity (kg)	Drawer Load Capacity (kg)	Compartment Load Capacity (kg)	Drawer Qty
STST74306-8	7 Drawers Roller Cabinet	690 x 426 x 889	Top 4: 540 x 408 x 72 Bottom 3: 540 x 408 x 105	300	20	—	7

5 TRAY CANTILEVER BOX

- Electro-powder coating to resist scratch & solvent markings
- Heavy duty metal for body construction & handle to provide ultimate durability
- Double latch for greater strength Tray swing out for easy tool access
- Double Handle for more comfort



PART No.	DESCRIPTION	SIZE	PBQ
1-94-738	Cantilever Tools Box 5 Tray Double Handle	460x200x200mm	1

5 TRAY CANTILEVER BOX

- Electro-powder coating to resist scratch & solvent markings
- Heavy duty metal for body construction & handle to provide ultimate durability
- Double latch for greater strength Tray swing out for easy tool access
- Double Handle for more comfort



PART No.	DESCRIPTION	SIZE	PBQ
STST81400	21"5 Tray Cantilever Tools Box Double Handle	21"	1



**HIGH QUALITY
TOOL SETS FOR
PROFESSIONAL
USE**

COMBINATION WRENCH (CWB)

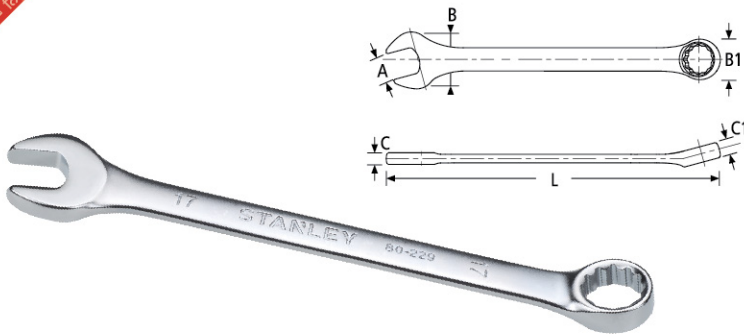

- ASME B107.17M, ASME B107.100, ASME B107.6
DIN 3113, ISO 1711-1, ISO 691
- Maxi-Drive™ system helps reduce fastener rounding
- 12-point ring angled at 15°



Bulk SKU #	Description	A (mm)	L (mm)	B (mm)	B1 (mm)	C (mm)	C1 (mm)	Weight (kg)	Box Qty
STMT80215-8B	Combination Wrench Basic 6mm	6	100.5	14.74	11.22	4.06	5.4	0.017	10
STMT80216-8B	Combination Wrench Basic 7mm	7	109.5	16.4	12	4.23	5.62	0.020	10
STMT80217-8B	Combination Wrench Basic 8mm	8	115.5	19.4	13.35	4.55	6.2	0.025	10
STMT80218-8B	Combination Wrench Basic 9mm	9	126.5	21	15.2	4.65	6.6	0.032	10
STMT80219-8B	Combination Wrench Basic 10mm	10	135.5	22.6	15.9	5.1	7.05	0.041	10
STMT80220-8B	Combination Wrench Basic 11mm	11	148.5	24.75	17.4	5.7	7.45	0.049	10
STMT80222-8B	Combination Wrench Basic 12mm	12	157.5	26.45	18.65	5.85	7.85	0.058	10
STMT80223-8B	Combination Wrench Basic 13mm	13	167	28.3	20	6.35	8.3	0.072	10
STMT80224-8B	Combination Wrench Basic 14mm	14	181	31.15	21.75	6.75	8.8	0.094	10
STMT80225-8B	Combination Wrench Basic 15mm	15	191	32.8	23	7.0	9.2	0.102	10
STMT80226-8B	Combination Wrench Basic 16mm	16	201	34.35	24.35	7.25	9.65	0.110	10
STMT80229-8B	Combination Wrench Basic 17mm	17	216.5	37.15	26.1	7.55	10.05	0.132	6
STMT80231-8B	Combination Wrench Basic 18mm	18	227	39	27.5	7.8	10.65	0.161	6
STMT80233-8B	Combination Wrench Basic 19mm	19	237.5	40.75	28.65	8	11.2	0.176	6
STMT80234-8B	Combination Wrench Basic 20mm	20	249	42.65	30.1	8.25	11.6	0.208	6
STMT80235-8B	Combination Wrench Basic 21mm	21	260.5	44.2	31.55	8.55	12	0.213	6
STMT80236-8B	Combination Wrench Basic 22mm	22	278	46.45	33.2	8.9	12.35	0.257	6
STMT80238-8B	Combination Wrench Basic 23mm	23	289	47.9	34.55	9.2	12.7	0.276	6
STMT80239-8B	Combination Wrench Basic 24mm	24	300.5	49.7	35.75	9.55	13.05	0.340	6
STMT80240-8B	Combination Wrench Basic 25mm	25	316.5	52	37.5	10	13.6	0.371	6
STMT80241-8B	Combination Wrench Basic 26mm	26	321.5	52.8	38.2	10.2	13.8	0.403	6
STMT80242-8B	Combination Wrench Basic 27mm	27	342.5	55.9	40.1	10.8	14.4	0.486	4
STMT80243-8B	Combination Wrench Basic 28mm	28	357.5	57.8	41.9	11.3	15	0.529	4
STMT80244-8B	Combination Wrench Basic 30mm	30	367.5	59.9	43.3	11.5	15.2	0.579	4
STMT80245-8B	Combination Wrench Basic 32mm	32	394.5	65.8	46.9	12.1	16.5	0.700	4

COMBINATION SPANNERS SETS

- Maxi-Drive™ system helps reduce fastener rounding
- Matt finishing ,Black Pouch



PART No.	DESCRIPTION	SIZE	PBQ
STMT80940-8	8 Pc - Combination Spanners Sets	8,10,11,12,13,14,17 & 19MM	1
STMT80942-8	11 Pc - Combination Spanners Sets	8,9,10,11,12,13,14,17,19,22 & 24MM	1
STMT80944-8	14 Pc - Combination Spanners Sets	8,9,10,12,13,14,17,19,21,22,24,27,30, & 32MM	1



T - HANDLE

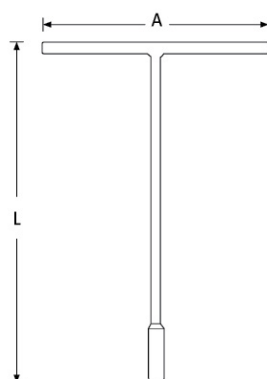

- ASME B107.5M, DIN 3124, ISO 691
- Cr-V steel
- Full polished finish
- For deep access
- Thin wall socket design



SKU #	Description	Size (mm)	L (mm)	A (mm)	Weight (kg)	Box Qty
STMT93302-8	T-handle 8mm	8	310	200	0.306	10
STMT93303-8	T-handle 9mm	9	310	200	0.312	10
STMT93304-8	T-handle 10mm	10	310	200	0.32	10
STMT93305-8	T-handle 11mm	11	310	200	0.322	10
STMT93306-8	T-handle 12mm	12	310	200	0.326	10
STMT93307-8	T-handle 13mm	13	310	250	0.36	10
STMT93308-8	T-handle 14mm	14	310	250	0.374	10
STMT93309-8	T-handle 17mm	17	310	250	0.552	10
STMT93311-8	T-handle 19mm	19	310	250	0.564	10

ADJUSTABLE WRENCH

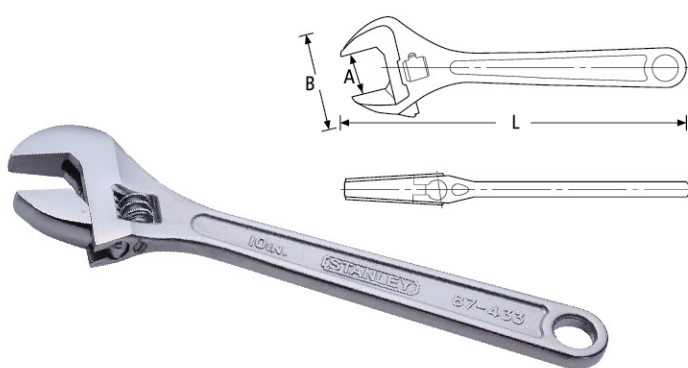

- ASME B107.100, ASME B107.8
- Adjustable jaw design allows tool to grip many fastener sizes
- Knurl adjusting mechanism for quick and precise adjustments
- Built-in tension spring stabilizes movable jaw
- Polished chrome head and chrome-plated body for anti-corrosion protection
- Laser-etched SAE and mm jaw scale for easy size adjustment
- Lightweight handle design



SKU #	Description	A (mm)	L (mm)	B (mm)	Weight (kg)	Box Qty
STMT87431-8	Adj. Wrench 150mm	≤19.3	150mm / 6"	19	0.14	6
STMT87432-8	Adj. Wrench 200mm	≤24	200mm / 8"	24	0.28	6
STMT87433-8	Adj. Wrench 250mm	≤30	250mm / 10"	29	0.41	6
STMT87434-8	Adj. Wrench 300mm	≤36	300mm / 12"	34	0.71	6
STMT87435-8	Adj. Wrench 375mm	≤46	375mm / 15"	43	1.42	4
1-87-371	Adj. Wrench 450mm		450mm / 18"			
97-797	Adj. Wrench 650mm		375mm / 24"			

COMBINATION SPANNERS SETS



- Anti-slip design on open end
- Maxi-Drive™ system helps reduce fastener rounding
- Chrome vanadium steel
- Matt finishing

PART No.	DESCRIPTION	SIZE	PBQ
70-963E	8 Pc - Combination Spanners Sets	8,9,10,11,13,14,17 & 19MM	1
70-964E	12 Pc - Combination Spanners Sets	6,7,8,9,10,12,13,14,17,19, & 22MM	1
70-965E	23 Pc - Combination Spanners Sets	6,7,8,9,10,12,13,14,15,16,17,18,19,20,21,22,23,24,25, 27,30, & 32MM	1



COMBINATION SPANNERS - MATTE FINISH



- IS 6131-1980
- Anti-slip design on open end
- Maxi-Drive™ system helps reduce fastener rounding
- Chrome vanadium steel
- Matt finishing



PART No.	DESCRIPTION	SIZE	A(MM)	L(MM)	B(MM)	B1(MM)	C(MM)	C1(MM)	WT.(KG)	PBQ
70-936E	Combination Spanner	6mm	6	100	15	10.2	3.6	5.4	0.015	10
70-937E	Combination Spanner	7mm	7	110	16	11.7	3.6	5.4	0.019	10
70-938E	Combination Spanner	8mm	8	120	18	13	4.1	6.4	0.025	10
70-939E	Combination Spanner	9mm	9	130	20	14.5	4.1	6.4	0.031	10
70-940E	Combination Spanner	10mm	10	140	22	15.8	4.6	7.9	0.039	10
70-941E	Combination Spanner	11mm	11	150	24.5	17.2	5.1	8.4	0.049	10
70-942E	Combination Spanner	12mm	12	160	27.5	18.5	5.1	8.4	0.058	10
70-943E	Combination Spanner	13mm	13	170	28.5	20	5.9	9.4	0.070	10
70-944E	Combination Spanner	14mm	14	180	30.5	21.5	5.9	9.9	0.088	10
70-945E	Combination Spanner	15mm	16	200	34.5	24	6.3	10.9	0.113	10
70-946E	Combination Spanner	16mm	17	210	37.5	25.5	6.5	10.9	0.128	10
70-947E	Combination Spanner	17mm	18	220	39.5	26.5	6.7	11.9	0.150	10
70-948E	Combination Spanner	18mm	19	230	42	28	7.2	11.9	0.171	10
70-949E	Combination Spanner	19mm	19	230	42	28	7.2	11.9	0.171	10
70-950E	Combination Spanner	20mm	20	240	43	29.5	7.7	12.4	0.210	10
70-951E	Combination Spanner	21mm	21	250	45	31.5	8.2	12.9	0.214	10
70-952E	Combination Spanner	22mm	22	260	47	33	8.7	12.9	0.233	10
70-953E	Combination Spanner	23mm	23	270	49	34	8.9	13.4	0.260	5
70-954E	Combination Spanner	24mm	24	280	51	36	8.9	13.9	0.290	5
70-955E	Combination Spanner	25mm	25	290	53.5	37	9.2	14.4	0.329	5
70-956E	Combination Spanner	26mm	26	300	55.2	38	9.4	15	0.215	5
70-957E	Combination Spanner	27mm	27	310	57.5	39.5	9.7	15.4	0.282	5
70-960E	Combination Spanner	30mm	30	340	60.5	43.5	10.2	16.4	0.495	5
70-961E	Combination Spanner	32mm	32	360	65.5	46.5	10.2	16.9	0.562	5



“ I BELIEVE THAT WITH THE RIGHT TOOLS, ANYTHING IS POSSIBLE. STANLEY'S WIDE VARIETY OF PRODUCTS HAS ENABLED ME TO PROVE NOT JUST TO THE WORLD, BUT TO MYSELF WHAT I CAN ACCOMPLISH ”

1/4" PEAR HEAD RATCHET P9



- ASME B107.10M-2005, ISO 3315, DIN 3122, ISO 1174-1
- Socket safety lock
- Lever reverse: rotation direction displayed
- Chrome vanadium steel
- Chemical resistant ergonomic bimaterial handle
- Quick release button



BULK SKU #	Description	L (mm)	D1 (mm)	D2 (mm)	Gear	Increment	Weight (kg)	Retail / BULK Box Qty
STMT95895-8B	1/4" Pear Head Ratchet P9	146	22.4	22.1	60	6°	0.1	10 / 8

1/4" BIT HOLDER

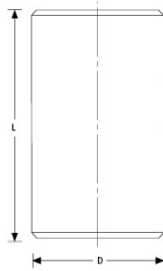

- ASME B107.10M
- For manual use



SKU #	Description	L (mm)	D (mm)	Weight (kg)	Box Qty
STMT86124-8B	1/4" Bit Holder	25.2	14.2	0.024	15

1/4" COUPLER

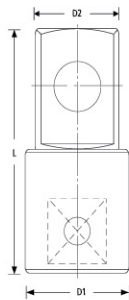

- ASME B107.10M, ISO 1174-1, ISO 691
- Chrome vanadium steel
- For manual use.



SKU #	Description	L (mm)	D1 (mm)	D2 (mm)	Weight (kg)	Box Qty
STMT86002-8B	Coupler 1/4" To 3/8"	25	12.2	10	0.016	15

1/4" SLIDING TEE

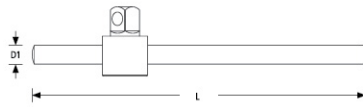

- ASME B107.10M, ISO 3316 - DIN 3123 - ISO 1174-1
- Sliding Head
- Chrome vanadium steel
- For manual use



SKU #	Description	L (mm)	D1 (mm)	Weight (kg)	Box Qty
STMT86010-8B	1/4" Sliding Tee	108	6.4	0.041	10

1/4" EXTENSION

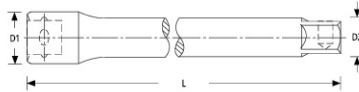

- ASME B107.10M, ISO 3316 - DIN 3123 - ISO 1174-1
- Fully polished finish
- Chrome vanadium steel
- For manual use



SKU #	Description	L (mm)	D1 (mm)	D2 (mm)	Weight (kg)	Box Qty
STMT91059-8B	1/4" Extension 50mm	51	12.5	8.2	0.025	11
STMT86006-8B	1/4" Extension 75mm	76.2	12.5	8.2	0.035	33
STMT91339-8B	1/4" Extension 100mm	101.6	12.5	8.2	0.045	33
STMT86007-8B	1/4" Extension 150mm	152.4	12.5	8.2	0.067	10

1/4" FLEXIBLE EXTENSION

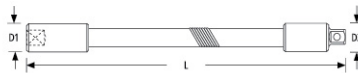

- ASME B107.10M, ISO 3316 - DIN 3123 - ISO 1174-1
- Fully polished finish
- Chrome vanadium steel
- For manual use



SKU #	Description	L (mm)	D1 (mm)	D2 (mm)	Weight (kg)	Box Qty
STMT86001-8B	1/4" Flexible Extension 150mm	150	12.2	12.2	0.064	10

1/4" UNIVERSAL JOINT



- ASME B107.10M, ISO 1174-2
- Chrome vanadium steel
- For manual use



SKU #	Description	L (mm)	D1 (mm)	D2 (mm)	Weight (kg)	Box Qty
STMT86011-8B	1/4" Universal Joint	34	14	6.3	0.0218	8

1/4" 6PTS STANDARD SOCKET

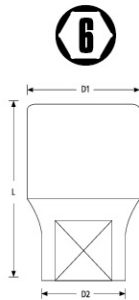

- ASME B107.5M, DIN 3124, ISO 1174-1, ISO 1711-1, ISO 691
- Maxi-Drive™ system helps reduce fastener rounding
- Chrome vanadium steel
- For manual use



SKU #	Description	L (mm)	D1 (mm)	D2 (mm)	Weight (kg)	Box Qty
STMT72872-8B	1/4" 6 PTS Standard Socket 3.5mm	25	12	6.4	0.010	18
STMT72873-8B	1/4" 6 PTS Standard Socket 4mm	25	12	6.9	0.010	18
STMT72874-8B	1/4" 6 PTS Standard Socket 4,5mm	25	12	7.5	0.011	18
STMT72875-8B	1/4" 6 PTS Standard Socket 5mm	25	12	8.1	0.010	18
STMT72876-8B	1/4" 6 PTS Standard Socket 5,5mm	25	12	8.8	0.010	18
STMT72877-8B	1/4" 6 PTS Standard Socket 6mm	25	12	9.4	0.011	18
STMT72878-8B	1/4" 6 PTS Standard Socket 7mm	25	12	10.9	0.012	18
STMT72879-8B	1/4" 6 PTS Standard Socket 8mm	25	12	11.5	0.012	18
STMT72880-8B	1/4" 6 PTS Standard Socket 9mm	25	13.2	12	0.015	15
STMT72881-8B	1/4" 6 PTS Standard Socket 10mm	25	14.7	13	0.020	15
STMT72882-8B	1/4" 6 PTS Standard Socket 11mm	25	16	13	0.023	13
STMT72883-8B	1/4" 6 PTS Standard Socket 12mm	25	16.9	13.5	0.025	8
STMT72884-8B	1/4" 6 PTS Standard Socket 13mm	25	14.7	14	0.028	8
STMT72885-8B	1/4" 6 PTS Standard Socket 14mm	25	19.7	16	0.036	8

3/8" PEAR HEAD RATCHET P9



- ASME B107.10M-2005, ISO 3315, DIN 3122, ISO 1174-1
- Socket safety lock
- Lever reverse: rotation direction displayed
- Chrome vanadium steel
- Chemical resistant ergonomic bimaterial handle
- Quick release button



BULK SKU #	Description	L (mm)	D1 (mm)	D2 (mm)	Gear	Increment	Weight (kg)	Retail / BULK Box Qty
STMT95894-8B	3/8" Pear Head Ratchet P9	202	27.8	29.51	60	6°	0.23	10 / 10

3/8" SLIDING TEE

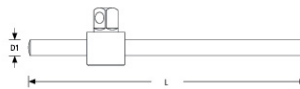

- ASME B107.10M, ISO 3315 - DIN 3122 - ISO 1174-1
- Sliding head
- Chrome vanadium steel
- For manual use



SKU #	Description	L (mm)	D1 (mm)	Weight (kg)	Box Qty
STMT86202-8B	3/8" Sliding Tee	170	9.5	0.133	4

3/8" EXTENSION

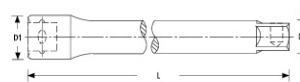

- ASME B107.10M, ISO 3316 - DIN 3123 - ISO 1174-1
- Full polished finishing
- Chrome vanadium steel
- For manual use



SKU #	Description	L (mm)	D1 (mm)	D2 (mm)	Weight (kg)	Box Qty
STMT86206-8B	3/8" Extension 75mm	76.2	17	12.2	0.073	3
STMT86207-8B	3/8" Extension 125mm	152.4	17	12.2	0.145	8
STMT86208-8B	3/8" Extension 250mm	245	17	12.2	0.23	21

3/8" BIT HOLDER

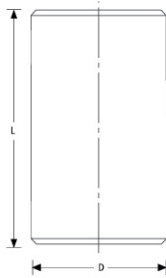

- ASME B107.10, ISO 1174-1, ISO 691
- Chrome vanadium steel
- For manual use



SKU #	Description	L (mm)	D (mm)	Weight (kg)	Box Qty
STMT86250-8B	3/8" Holder For 1/4 Bits	28.6	17.3	0.024	11

3/8" COUPLER

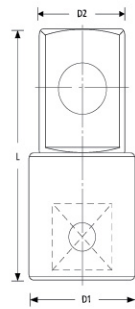

- ASME B107.10M, ISO 1174-1, ISO 691
- Chrome vanadium steel
- For manual use



SKU #	Description	L (mm)	D1 (mm)	D2 (mm)	Weight (kg)	Box Qty
STMT86214-8B	Coupler 3/8" To 1/4"	25.4	17.4	6.3	0.020	12
STMT86215-8B	Coupler 3/8" To 1/2"	36	18	10	0.044	8

3/8" UNIVERSAL JOINT



- ASME B107.10M, ISO 1174-2
- Chrome vanadium steel
- For manual use



SKU #	Description	L (mm)	D1 (mm)	D2 (mm)	Weight (kg)	Box Qty
STMT86211-8B	3/8" Universal Joint	54.2	19	10	0.060	8

3/8" SPEED HANDLE

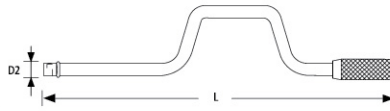

- ASME B107.10M, ISO 3315 - DIN 3122 - ISO 1174-1
- Fast rotation
- Rotating handle
- Knurled handle



SKU #	Description	L (mm)	D2 (mm)	Weight (kg)	Box Qty
STMT86212-8B	3/8" Speed Handle	380	17	0.318	6

3/8" SWIVEL HANDLE

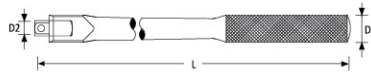

- ASME B107.10M, ISO 3315 - DIN 3122 - ISO 1174-1
- Smooth-action joint
- Hinged handle for easier access
- Knurled handle



SKU #	Description	L (mm)	Weight (kg)	Box Qty
STMT86213-8B	3/8" Swivel Handle 200mm	215.5	0.234	6

3/8" 6PTS STANDARD SOCKET

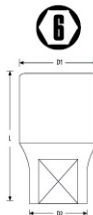

- ASME B107.5M, DIN 3124, ISO 1174-1, ISO 1711-1, ISO 691
- Maxi-Drive™ system helps reduce fastener rounding
- Chrome vanadium steel
- For manual use



SKU #	Description	L (mm)	D1 (mm)	D2 (mm)	Weight (kg)	Box Qty
STMT72914-8B	3/8" 6 PTS Standard Socket 6mm	25.7	17.1	10.1	0.02	12
STMT72915-8B	3/8" 6 PTS Standard Socket 7mm	25.7	17.1	11	0.021	12
STMT72916-8B	3/8" 6 PTS Standard Socket 8mm	25.7	17.1	12.2	0.025	12
STMT72917-8B	3/8" 6 PTS Standard Socket 9mm	25.7	17.1	13.2	0.022	12
STMT72918-8B	3/8" 6 PTS Standard Socket 10mm	25.7	17.1	14.7	0.022	12
STMT72919-8B	3/8" 6 PTS Standard Socket 11mm	25.7	17.1	16	0.024	12
STMT72920-8B	3/8" 6 PTS Standard Socket 12mm	25.7	17.1	16.5	0.024	12
STMT72921-8B	3/8" 6 PTS Standard Socket 13mm	25.7	18.3	17	0.026	12
STMT72922-8B	3/8" 6 PTS Standard Socket 14mm	25.7	19.5	18	0.028	11
STMT72923-8B	3/8" 6 PTS Standard Socket 15mm	25.7	20.4	18	0.028	11
STMT72924-8B	3/8" 6 PTS Standard Socket 16mm	29	22.1	19	0.038	15
STMT72925-8B	3/8" 6 PTS Standard Socket 17mm	29	23.3	19	0.042	14
STMT72926-8B	3/8" 6 PTS Standard Socket 18mm	29	24.2	20	0.046	14
STMT72927-8B	3/8" 6 PTS Standard Socket 19mm	29	25.5	21	0.054	11
STMT72928-8B	3/8" 6 PTS Standard Socket 20mm	29	26.8	22	0.05	10
STMT72929-8B	3/8" 6 PTS Standard Socket 21mm	29	27.7	23	0.056	9
STMT72930-8B	3/8" 6 PTS Standard Socket 22mm	29	29.5	24	0.072	8
STMT72931-8B	3/8" 6 PTS Standard Socket 23mm	29	30.7	25	0.07	8
STMT72932-8B	3/8" 6 PTS Standard Socket 24mm	29	31	26	0.075	7

1/2" PEAR HEAD RATCHET P9



- ASME B107.10M-2005, ISO 3315, DIN 3122, ISO 1174-1
- Socket safety lock
- Lever reverse: rotation direction displayed
- Chrome vanadium steel
- Chemical resistant ergonomic bimaterial handle
- Quick release button



BULK SKU #	Description	L (mm)	D1 (mm)	D2 (mm)	Gear	Increment	Weight (kg)	Retail / BULK Box Qty
STMT95893-8B	1/2" Pear Head Ratchet P9	256.5	32.5	35.7	60	6°	0.425	5 / 5

1/2" EXTENSION

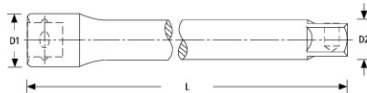

- ASME B107.10M, ISO 3316 - DIN 3123 - ISO 1174-1
- Fully polished finish
- Chrome vanadium steel
- For manual use



SKU #	Description	L (mm)	D1 (mm)	D2 (mm)	Weight (kg)	Box Qty
STMT88930-8B	1/2" Extension 75mm	76.2	22.5	16.3	0.123	5
STMT86407-8B	1/2" Extension 125mm	125	22.5	16.3	0.22	6
STMT86408-8B	1/2" Extension 250mm	252	22.5	16.3	0.42	12

1/2" SWIVEL HANDLE

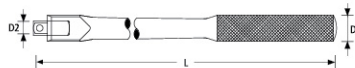

- ASME B107.10M, ISO 3315 - DIN 3122 - ISO 1174-1
- Smooth-action joint
- Hinged handle for easier grip
- Knurl surface handle design to anti-slip



SKU #	Description	L (mm)	D1 (mm)	D2 (mm)	Weight (kg)	Box Qty
STMT86405-8B	1/2" 250mm Swivel Handle	254	28	21	0.5338	4

1/2" COUPLER

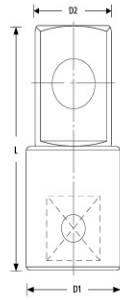

- ASME B107.10M, ISO 1174-1, ISO 691
- Chrome vanadium steel
- For manual use



SKU #	Description	L (mm)	D1 (mm)	D2 (mm)	Weight (kg)	Box Qty
STMT86414-8B	Coupler 1/2" to 3/8"	34.5	22	10	0.046	15
STMT88558-8B	Coupler 1/2" to 3/4"	42	25.2	19	0.111	12

1/2" UNIVERSAL JOINT



- ASME B107.10M, ISO 1174-2
- Chrome vanadium steel
- For manual use



SKU #	Description	L (mm)	D1 (mm)	D2 (mm)	Weight (kg)	Box Qty
STMT86411-8B	1/2" Universal Joint	68.5	24.9	12.5	0.1426	10

1/2" SPEED HANDLE



- ASME B107.10M, ISO 3315 - DIN 3122 - ISO 1174-1
- Fast rotation handle
- Knurled handle



SKU #	Description	L (mm)	D2 (mm)	Weight (kg)	Box Qty
STMT86412-8B	1/2" Speed Handle	420	21	0.554	4

1/2" 6PTS STANDARD SOCKET

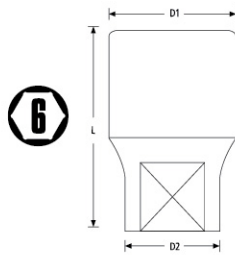

- ASME B107.5M, DIN 3124, ISO 1174-1, ISO 1711-1, ISO 691
- Maxi-Drive™ system helps reduce fastener rounding
- Chrome vanadium steel
- For manual use



SKU #	Description	L (mm)	D1 (mm)	D2 (mm)	Weight (kg)	Box Qty
STMT72933-8B	1/2" 6 PTS Standard Socket 8mm	38	21.8	12.4	0.045	15
STMT72934-8B	1/2" 6 PTS Standard Socket 9mm	38	21.8	14	0.048	15
STMT72935-8B	1/2" 6 PTS Standard Socket 10mm	38	21.8	15.5	0.048	15
STMT72936-8B	1/2" 6 PTS Standard Socket 11mm	38	21.8	16.7	0.05	15
STMT72937-8B	1/2" 6 PTS Standard Socket 12mm	38	21.8	18	0.053	15
STMT72938-8B	1/2" 6 PTS Standard Socket 13mm	38	21.8	19.2	0.052	15
STMT72939-8B	1/2" 6 PTS Standard Socket 14mm	38	21.8	20.5	0.056	15
STMT72940-8B	1/2" 6 PTS Standard Socket 15mm	38	21.8	21	0.054	15
STMT72941-8B	1/2" 6 PTS Standard Socket 16mm	38	23.3	22.5	0.064	14
STMT72942-8B	1/2" 6 PTS Standard Socket 17mm	38	24	23	0.07	12
STMT72943-8B	1/2" 6 PTS Standard Socket 18mm	38	24.8	23	0.07	12
STMT72944-8B	1/2" 6 PTS Standard Socket 19mm	38	26.3	24	0.074	9
STMT72945-8B	1/2" 6 PTS Standard Socket 20mm	38	26.8	24	0.066	9
STMT72946-8B	1/2" 6 PTS Standard Socket 21mm	38	27.7	24	0.084	9
STMT72947-8B	1/2" 6 PTS Standard Socket 22mm	40	29.8	26	0.098	4
STMT72948-8B	1/2" 6 PTS Standard Socket 23mm	40	30.8	26	0.098	4
STMT72949-8B	1/2" 6 PTS Standard Socket 24mm	40	31.8	26	0.1	4
STMT72950-8B	1/2" 6 PTS Standard Socket 25mm	40	32.8	27	0.115	2
STMT72951-8B	1/2" 6 PTS Standard Socket 26mm	43	33.8	28.8	0.11	2
STMT72952-8B	1/2" 6 PTS Standard Socket 27mm	43	35.8	29.5	0.136	2
STMT72953-8B	1/2" 6 PTS Standard Socket 28mm	43	37.6	30.5	0.142	2
STMT72954-8B	1/2" 6 PTS Standard Socket 29mm	43	37.8	31.5	0.145	2
STMT72955-8B	1/2" 6 PTS Standard Socket 30mm	43	39.8	32.5	0.184	2
STMT72956-8B	1/2" 6 PTS Standard Socket 32mm	43	41.8	34.5	0.23	2
STMT72957-8B	1/2" 6 PTS Standard Socket 34mm	45.5	43.8	36.5	0.3	3
STMT72958-8B	1/2" 6 PTS Standard Socket 36mm	57.2	49.8	38	0.45	2

1/2" L-HANDLE

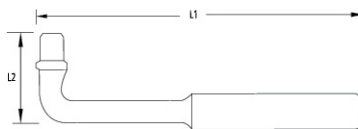

- ASME B107.10M, ISO 1174-1, ISO 691 SO 1174-1, ISO 691
- Chrome vanadium steel
- Knurled handle



SKU #	Description	L1 (mm)	L2 (mm)	Weight (kg)	Box Qty
STMT86493-8B	1/2" L-Handle 90 degree	200	50	0.304	4

1/2" 6PTS DEEP SOCKET



- ASME B107.5M, ISO 1174-1, ISO 1711-1, ISO 691
- Maxi-Drive™ system helps reduce fastener rounding
- Chrome vanadium steel
- For manual use



SKU #	Description	L (mm)	D1 (mm)	D2 (mm)	Weight (kg)	Box Qty
STMT73324-8B	1/2" 6 PTS Deep Socket 10mm	79	22	15.5	0.125	8
STMT73325-8B	1/2" 6 PTS Deep Socket 11mm	79	22	16.7	0.13	8
STMT73326-8B	1/2" 6 PTS Deep Socket 12mm	79	22	18	0.113	8
STMT73327-8B	1/2" 6 PTS Deep Socket 13mm	79	22	19.2	0.12	8
STMT73328-8B	1/2" 6 PTS Deep Socket 14mm	79	22	20.5	0.12	8
STMT73329-8B	1/2" 6 PTS Deep Socket 15mm	79	22	21	0.115	8
STMT73330-8B	1/2" 6 PTS Deep Socket 16mm	79	23.3	22.5	0.131	6
STMT73331-8B	1/2" 6 PTS Deep Socket 17mm	79	24	-	0.155	6
STMT73332-8B	1/2" 6 PTS Deep Socket 18mm	79	25.3	-	0.165	6
STMT73333-8B	1/2" 6 PTS Deep Socket 19mm	79	26.5	-	0.186	4
STMT73334-8B	1/2" 6 PTS Deep Socket 21mm	79	27.8	-	0.19	6
STMT73335-8B	1/2" 6 PTS Deep Socket 22mm	79	27.8	-	0.222	5
STMT73336-8B	1/2" 6 PTS Deep Socket 23mm	79	30.8	-	0.25	5
STMT73337-8B	1/2" 6 PTS Deep Socket 24mm	79	31.8	-	0.255	5
STMT73338-8B	1/2" 6 PTS Deep Socket 27mm	79	35.8	-	0.325	4
STMT73339-8B	1/2" 6 PTS Deep Socket 30mm	79	39.8	-	0.45	2
STMT73340-8B	1/2" 6 PTS Deep Socket 32mm	79	41.3	-	0.52	2



IT'S EASY TO UNDERSTAND IF THERE ARE NO DAMAGED NUTS ON A CAR BEING SERVICED, THAT MAXI-DRIVE PROFILE SOCKETS WERE BEING USED. GUARANTEED NOT TO LEAVE ANY PROBLEMS BEHIND.

1/2" HEXAGON BIT SOCKET

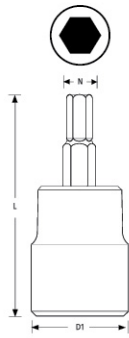

- ISO 1173, ISO 2380-1, ISO 2351-1, ISO 1174-1, ISO 691
- S2 Steel bit
- HRC 60 +/- 2, 20% higher torque vs Cr-V
- For manual use



SKU #	Description	L (mm)	D1 (mm)	N (mm)	Weight (kg)	Box Qty
STMT73371-8B	1/2" Hexagonal Bit Socket 4mm	55	22	4	0.06	6
STMT73372-8B	1/2" Hexagonal Bit Socket 5mm	55	22	5	0.06	6
STMT73373-8B	1/2" Hexagonal Bit Socket 6mm	55	22	6	0.06	6
STMT73374-8B	1/2" Hexagonal Bit Socket 7mm	55	22	7	0.06	6
STMT73375-8B	1/2" Hexagonal Bit Socket 8mm	55	22	8	0.065	6
STMT73376-8B	1/2" Hexagonal Bit Socket 9mm	55	22	9	0.075	6
STMT73377-8B	1/2" Hexagonal Bit Socket 10mm	55	22	10	0.08	6
STMT73378-8B	1/2" Hexagonal Bit Socket 12mm	55	22	12	0.085	6
STMT73379-8B	1/2" Hexagonal Bit Socket 14mm	55	22	14	0.098	6
STMT73380-8B	1/2" Hexagonal Bit Socket 17mm	55	25	17	0.14	3
STMT73381-8B	1/2" Hexagonal Bit Socket 19mm	60	27.9	19	0.16	2

1/2" TORX BIT SOCKET

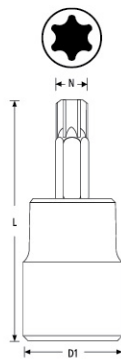

- ISO 1173, ISO 2380-1, ISO 2351-1, ISO 1174-1, ISO 691
- S2 Steel bit
- HRC 60 +/- 2, 20% higher torque vs Cr-V
- For manual use



SKU #	Description	L (mm)	D1 (mm)	N (mm)	Weight (kg)	Box Qty
STMT73389-8B	1/2" Torx Bit Socket T20	55	22	T20	0.052	6
STMT73390-8B	1/2" Torx Bit Socket T25	55	22	T25	0.052	6
STMT73391-8B	1/2" Torx Bit Socket T27	55	22	T27	0.052	6
STMT73392-8B	1/2" Torx Bit Socket T30	55	22	T30	0.052	6
STMT73393-8B	1/2" Torx Bit Socket T40	55	22	T40	0.052	6
STMT73394-8B	1/2" Torx Bit Socket T45	55	22	T45	0.060	6
STMT73395-8B	1/2" Torx Bit Socket T50	55	22	T50	0.062	6
STMT73396-8B	1/2" Torx Bit Socket T55	55	22	T55	0.072	6
STMT73397-8B	1/2" Torx Bit Socket T60	55	22	T60	0.075	6

1/2" TORX SOCKET

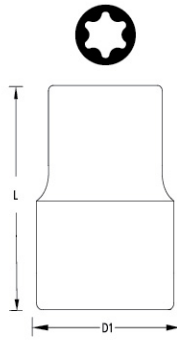

- ISO 1174-1
- For male Torx® screws
- Chrome vanadium steel



SKU #	Description	L (mm)	D1 (mm)	Weight (kg)	Box Qty
STMT73362-8B	1/2" Torx Socket E10	40	22	0.05	15
STMT73363-8B	1/2" Torx Socket E11	40	22	0.05	15
STMT73364-8B	1/2" Torx Socket E12	40	22	0.052	15
STMT73365-8B	1/2" Torx Socket E14	40	22	0.052	15
STMT73366-8B	1/2" Torx Socket E16	40	22	0.056	15
STMT73367-8B	1/2" Torx Socket E18	40	22	0.056	15
STMT73368-8B	1/2" Torx Socket E20	40	23.5	0.058	15
STMT73369-8B	1/2" Torx Socket E22	40	25	0.09	12
STMT73370-8B	1/2" Torx Socket E24	40	27	0.107	9



60 teeth mechanism offers the perfect combination of durability and precision.

3/4" RATCHET

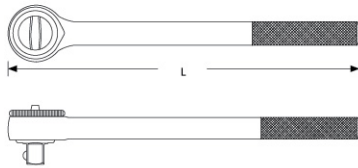

- ASME B107.10M-2005, ISO 3315, DIN 3122, ISO 1174-1
- Chrome vanadium steel
- Knurled handle



SKU #	Description	L (mm)	Gear	Increment	Weight (kg)	Box Qty
STMT91316-8B	3/4" Ratchet With Handle	500	45	8	2.56	2

3/4" SLIDING TEE

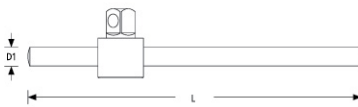

- ASME B107.10M, ISO 3315 - DIN 3122 - ISO 1174-1
- Sliding head
- Chrome vanadium steel
- For manual use



SKU #	Description	L (mm)	D1 (mm)	Weight (kg)	Box Qty
STMT89303-8B	3/4" Sliding Tee	483	20	1.437	2

3/4" EXTENSION

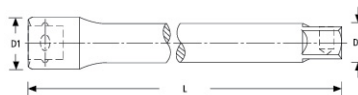

- ASME B107.10M, ISO 3316 - DIN 3123 - ISO 1174-1
- Fully polished finish
- Chrome vanadium steel
- For manual use



SKU #	Description	L (mm)	D1 (mm)	D2 (mm)	Weight (kg)	Box Qty
STMT89306-8B	3/4" Extension 100mm	102	35.5	23	0.44	4
STMT89307-8B	3/4" Extension 200mm	203	35.5	23	0.72	4
STMT89308-8B	3/4" Extension 400mm	406	35.5	23	1.24	2

3/4" COUPLER

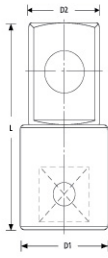

- ASME B107.10M, ISO 1174-1, ISO 691
- Chrome vanadium steel
- For manual use



SKU #	Description	L (mm)	D1 (mm)	D2 (mm)	Weight (kg)	Box Qty
STMT88908-8B	Coupler 3/4" to 1/2"	48	35	12.5	0.125	4
STMT88909-8B	Coupler 3/4" to 1"	62	37.3	25.4	0.16	4

3/4" UNIVERSAL JOINT

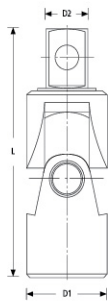

- ASME B107.10M, ISO 1174-2
- Chrome vanadium steel
- For manual use



SKU #	Description	L (mm)	D1 (mm)	D2 (mm)	Weight (kg)	Box Qty
STMT93091-8B	3/4" Universal Joint	110	40	19	0.225	4

3/4" SWIVEL HANDLE



- ASME B107.10M, ISO 3315 - DIN 3122 - ISO 1174-1
- Smooth-action joint
- Hinged handle for easier access
- Knurled handle



SKU #	Description	L (mm)	Weight (kg)	Box Qty
STMT89302-8B	3/4" Swivel Handle	510	1.406	2

3/4" 6PTS STANDARD SOCKET

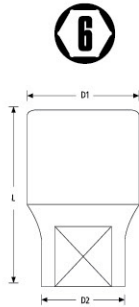

- ASME B107.5M, DIN 3124, ISO 1174-1, ISO 1711-1, ISO 691
- Chrome vanadium steel
- For manual use



SKU #	Description	L (mm)	D1 (mm)	D2 (mm)	Weight (kg)	Box Qty
STMT89319-8B	3/4" 6PTS Socket 19mm	50	36	29.3	0.213	4
STMT89322-8B	3/4" 6PTS Socket 22mm	50	36	31.3	0.217	4
STMT89324-8B	3/4" 6PTS Socket 24mm	51	36	33.3	0.216	4
STMT89325-8B	3/4" 6PTS Socket 25mm	52	36	34.3	0.216	4
STMT89327-8B	3/4" 6PTS Socket 27mm	52	36	36	0.219	4
STMT89328-8B	3/4" 6PTS Socket 28mm	52	38	38	0.254	4
STMT89330-8B	3/4" 6PTS Socket 30mm	54	38	40	0.285	4
STMT89332-8B	3/4" 6PTS Socket 32mm	56	38	42	0.315	4
STMT89333-8B	3/4" 6PTS Socket 33mm	56	38	44	0.329	4
STMT89334-8B	3/4" 6PTS Socket 34mm	56	38	44	0.332	4
STMT89336-8B	3/4" 6PTS Socket 36mm	58	42	50	0.417	4
STMT89338-8B	3/4" 6PTS Socket 38mm	60	45	52	0.479	4
STMT89341-8B	3/4" 6PTS Socket 41mm	64	45	56	0.573	4
STMT89346-8B	3/4" 6PTS Socket 46mm	68	48	62	0.684	4
STMT89350-8B	3/4" 6PTS Socket 50mm	72	48	68	0.852	4



“ FOR GOOD REASON, WE CALL THE 3/4 RANGE THE MAMMOTH OF ALL SOCKETS AS THEY ARE SO HUGE AND STURDY. HOWEVER UNLIKE THE GIANT CREATURES, WE KNOW THAT THIS RANGE WILL PROBABLY NOT GO EXTINCT AS THEY ARE SIMPLE UNBREAKABLE. ”

DUAL WAY TORQUE WRENCH

48 GEAR TEETH FOR SMALL INCREMENT SETTING

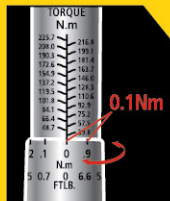

“ THIS TOOL HAS A SMOOTH ACTION AND FINE RATCHET, PLUS THE ABILITY TO TIGHTEN ACCURATELY IN BOTH DIRECTIONS. ”

1/4" TORQUE WRENCH 5-25 NM

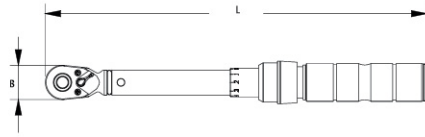

- ISO 6789, ASME B107.14
- Accuracy: +/- 4%
- Visual and audible indication
- Dual Way direction(C.W./C.C.W.) click Type
- Dual scales (N-m & in-lb.)
- Quick release button
- Adjusting ring locking system
- Aluminum Alloy handle with anodic treatment
- Si-Cr-Mo spring
- Cr-Mo pawl
- Cr-Mo square driver
- 48 Gear teeth



SKU #	Description	Drive Size	Torque Range	Torque Range	Increment	B (mm)	L (mm)	Weight (kg)
STMT73587-8	1/4" Torque Wrench 5-25 N-m	1/4"	5-25 N-m	48.7-225.7 in-lb.	0.1 N-m	22.5	246	0.365

3/8" TORQUE WRENCH 10-50NM

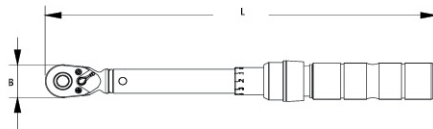

- ISO 6789, ASME B107.14
- Accuracy: +/- 4%
- Visual and audible indication
- Dual Way direction(C.W./C.C.W.) click Type
- Dual scales (N-m & ft-lb.)
- Quick release button
- Adjusting ring locking system
- Aluminum Alloy handle with anodic treatment
- Si-Cr-Mo spring
- Cr-Mo pawl
- Cr-Mo square driver
- 48 Gear teeth



SKU #	Description	Drive Size	Torque Range	Torque Range	Increment	B (mm)	L (mm)	Weight (kg)
STMT73588-8	3/8" Torque Wrench 10-50N-m	3/8"	10-50 N-m	9.2-38.7 ft-lb	0.5 N-m	31	409	1.182

1/2" TORQUE WRENCH 20-100NM

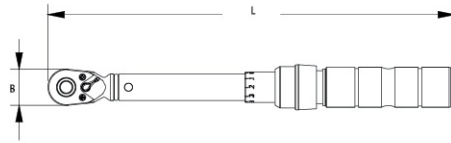

- ISO 6789, ASME B107.14
- Accuracy: +/- 4%
- Visual and audible indication
- Dual Way direction(C.W./C.C.W.) click Type
- Dual scales (N-m & ft-lb)
- Quick release button
- Adjusting ring locking system
- Aluminum Alloy handle with anodic treatment
- Si-Cr-Mo spring
- Cr-Mo pawl
- Cr-Mo square driver
- 48 Gear teeth



SKU #	Description	Drive Size	Torque Range	Torque Range	Increment	B (mm)	L (mm)	Weight (kg)
STMT73589-8	1/2" Torque Wrench 20-100N-m	1/2"	20-100 N-m	16.6-75.6 ft-lb	0.5 N-m	31	409	1.19

1/2" TORQUE WRENCH 40-200NM

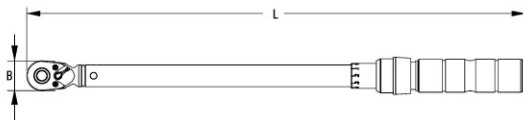

- ISO 6789, ASME B107.14
- Accuracy: +/- 4%
- Visual and audible indication
- Dual Way direction(C.W./C.C.W.) Click Type
- Dual scales (N-m & ft-lb)
- Quick release button
- Adjusting ring locking system
- Aluminum Alloy handle with anodic treatment
- Si-Cr-Mo spring
- Cr-Mo pawl
- Cr-Mo square driver
- 48 Gear teeth



SKU #	Description	Drive Size	Torque Range	Torque Range	Increment	B (mm)	L (mm)	Weight (kg)
STMT73590-8	1/2" Torque Wrench 40-200N-m	1/2"	40-200 N-m	33.2-151.2 ft-lb	1 N-m	41	519	1.6

1/2" TORQUE WRENCH 60-340NM

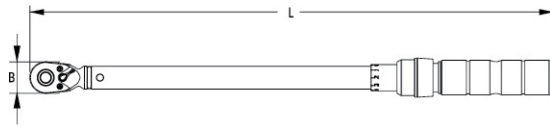

- ISO 6789, ASME B107.14
- Accuracy: +/- 4%
- Visual and audible indication
- Dual Way direction(C.W./C.C.W.) click Type
- Dual scales (N-m & ft-lb)
- Quick release button
- Adjusting ring locking system
- Aluminum Alloy handle with anodic treatment
- Si-Cr-Mo spring
- Cr-Mo pawl
- Cr-Mo square driver
- 48 Gear teeth



SKU #	Description	Drive Size	Torque Range	Torque Range	Increment	B (mm)	L (mm)	Weight (kg)
STMT73591-8	1/2" Torque Wrench 60-340N-m	1/2"	60-340 N-m	51.6-258.1 ft-lb	2 N-m	41	610	1.785

3/4" TORQUE WRENCH 150-750NM

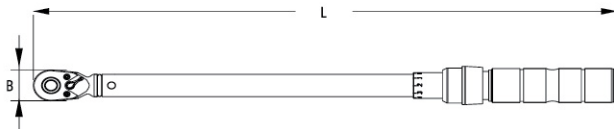

- ISO 6789, ASME B107.14
- Accuracy: +/- 4%
- Visual and audible indication
- Dual Way direction(C.W./C.C.W.) click Type
- Dual scales (N-m & ft-lb)
- Quick release button
- Adjusting ring locking system
- Aluminum Alloy handle with anodic treatment
- Si-Cr-Mo spring
- Cr-Mo pawl
- Cr-Mo square driver
- 48 Gear teeth



SKU #	Description	Drive Size	Torque Range	Torque Range	Increment	B (mm)	L (mm)	Weight (kg)
STMT73592-8	3/4" Torque Wrench 150-750N-m	3/4"	150-750 N-m	110-550 ft-lb	2.5 N-m	58	1112	5.87

9PCS LONG TORX KEY SET



- ANSI B18.3.2M-1979 ,GGG-K-275D
- S2 steel
- HRC 60 +/- 2, increase 20% torque than Cr-V
- Fine satin finish



SKU #	Description	Size (mm)	Qty	Weight (kg)	Box Qty
STMT92625-8	9 PCS Long Torx Key S et (T10 to T50)	TT10, TT15, TT20, TT25, TT27, TT30, TT40, TT45, TT50	9	0.33	6

9PCS LONG HEX KEY SET



- ANSI B18.3.2M-1979 ,GGG-K-275D
- S2 steel
- HRC 60 +/- 2, 20% higher torque vs Cr-V
- Fine satin finish



SKU #	Description	Size (mm)	Qty	Weight (kg)	Box Qty
STMT92619-8	9 PCS Long Hex Key Set	1.5, 2, 2.5, 3, 4, 5, 6, 8, 10	9	0.394	6

10PCS HEX KEY RING SET

- ANSI B18.3.2M-1979 ,GGG-K-275D
- Cr-V steel
- Anti-corrosion treatment
- Black Phosphate finish



SKU #	Description	Size (mm)	Qty	Weight (kg)	Box Qty
STMT69213-8	10 PCS Hex Key Ring Set -Metric	1.5, 2, 2.5, 3, 4, 5, 5.5, 6, 8, 10	10	0.28	12
69-230	10 PCS Hex Key Ring Set - Imperial	1/16, 5/64, 3/32, 1/8, 5/32, 3/16, 7/32, 1/4, 5/16, 3/8	10	0.30	12

LONG HEX KEY

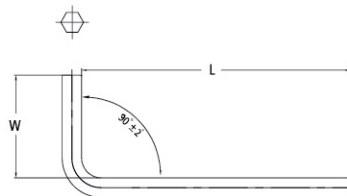

- ANSI B18.3.2M-1979 ,GGG-K-275D
- S2 steel
- HRC 60 +/- 2, 20% higher torque vs Cr-V
- Fine satin finish



SKU #	Description	Size (mm)	Qty	L (mm)	W (mm)	Weight (kg)	Box Qty
STMT94110-8	Long Hex Key 1.5mm (6 PCS)	1.5	6	187	55	0.016	72
STMT94111-8	Long Hex Key 2mm (6 PCS)	2	6	187	55	0.022	72
STMT94112-8	Long Hex Key 2.5mm (6 PCS)	2.5	6	187	55	0.033	72
STMT94113-8	Long Hex Key 3mm (6 PCS)	3	6	187	55	0.05	72
STMT94114-8	Long Hex Key 4mm (6 PCS)	4	6	269	81	0.096	72
STMT94115-8	Long Hex Key 5mm (6 PCS)	5	6	269	81	0.157	72
STMT94116-8	Long Hex Key 6mm (6 PCS)	6	6	269	81	0.258	72
STMT94118-8	Long Hex Key 8mm (6 PCS)	8	6	302	102	0.524	72
STMT94119-8	Long Hex Key 10mm (3 PCS)	10	3	302	102	0.441	36

CUSHION GRIP™ PHILLIPS®

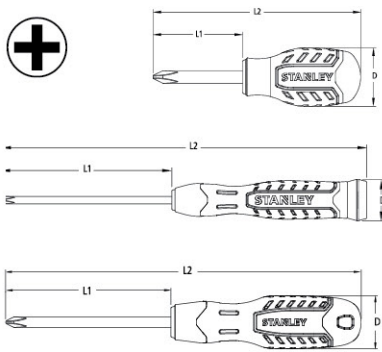

- Bi-material (PP+TPR) soft grip handle providing excellent comfort
- Chrome Vanadium (Cr-V) blade for durability
- Magnetic tips for easy pick up and screw locator
- Three-sided handle allowing more torque with anti-slip and anti-rolling features
- Ergonomic design with finger point in neck-down area for precise control
- Built-in hang hole for easy storage
- Screw tip identification on the handle for organization



Retail SKU #	Description	Tip Size	L1 (mm)	L2 (mm)	D (mm)
STMT60800-8	Cushion Grip Phillips PH0 X 60mm	PH0	60	76.5	16.5
STMT60801-8	Cushion Grip Phillips PH0 X 100mm	PH0	100	116.5	16.5
STMT60802-8	Cushion Grip Phillips PH0 X 125mm	PH0	125	141.5	16.5
STMT60803-8	Cushion Grip Phillips PH0 X 150mm	PH0	150	166.5	16.5
STMT60804-8	Cushion Grip Phillips PH1 X 75mm	PH1	75	104.5	29.5
STMT60805-8	Cushion Grip Phillips PH1 X 100mm	PH1	100	129.5	29.5
STMT60806-8	Cushion Grip Phillips PH1 X 150mm	PH1	150	179.5	29.5
STMT60807-8	Cushion Grip Phillips PH1 X 200mm	PH1	200	229.5	29.5
STMT60808-8	Cushion Grip Phillips PH2 X 45mm	PH2	45	74.2	29.2
STMT60809-8	Cushion Grip Phillips PH2 X 100mm	PH2	100	132.2	32.2
STMT60810-8	Cushion Grip Phillips PH2 X 125mm	PH2	125	157.2	32.2
STMT60811-8	Cushion Grip Phillips PH2 X 150mm	PH2	150	182.2	32.2
STMT60812-8	Cushion Grip Phillips PH2 X 200mm	PH2	200	232.2	32.2
STMT60813-8	Cushion Grip Phillips PH2 X 250mm	PH2	250	282.2	32.2
STMT60814-8	Cushion Grip Phillips PH3 X150mm	PH3	150	184.3	34.3
STMT60815-8	Cushion Grip Phillips PH3 X200mm	PH3	200	234.3	34.3
STMT60816-8	Cushion Grip Phillips PH3 X250mm	PH3	250	284.3	34.3



ERGONOMIC HANDLE PROFILES

Grip and drive screws securely, even when working with restricted access.

CUSHION GRIP™ SLOTTED FLARED

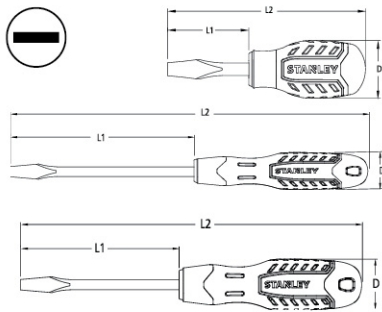

- Bi-material (PP+TPR) soft grip handle providing excellent comfort
- Chrome Vanadium (Cr-V) blade for durability
- Magnetic tips for easy pick up and screw locator
- Three-sided handle allowing more torque with anti-slip and anti-rolling features
- Ergonomic design with finger point in neck-down area for precise control
- Built-in hang hole for easy storage
- Screw tip identification on the handle for faster accessibility



Retail SKU #	Description	Tip Size	L1 (mm)	L2 (mm)	D (mm)
STMT60817-8	Cushion Grip Standard 3mm X 75mm	3mm	75	91.5	16.5
STMT60818-8	Cushion Grip Standard 3mm X 100mm	3mm	100	116.5	16.5
STMT60819-8	Cushion Grip Standard 3mm X 125mm	3mm	125	141.5	16.5
STMT60820-8	Cushion Grip Standard 3mm X 150mm	3mm	150	166.5	16.5
STMT60821-8	Cushion Grip Standard 5mm X 75mm	5mm	75	104.5	29.5
STMT60822-8	Cushion Grip Standard 5mm X 100mm	5mm	100	129.5	29.5
STMT60823-8	Cushion Grip Standard 5mm X 150mm	5mm	150	179.5	29.5
STMT60824-8	Cushion Grip Standard 5mm X 200mm	5mm	200	229.5	29.5
STMT60825-8	Cushion Grip Standard 6.5mm X 45mm	6.5mm	45	74.2	29.2
STMT60826-8	Cushion Grip Standard 6.5mm X 100mm	6.5mm	100	132.2	32.2
STMT60827-8	Cushion Grip Standard 6.5mm X 125mm	6.5mm	125	157.2	32.2
STMT60828-8	Cushion Grip Standard 6.5mm X 150mm	6.5mm	150	182.2	32.2
STMT60829-8	Cushion Grip Standard 6.5mm X 200mm	6.5mm	200	203.2	32.2
STMT60830-8	Cushion Grip Standard 6.5mm X 250mm	6.5mm	250	282.2	32.2
STMT60831-8	Cushion Grip Standard 8mm X 150mm	8mm	150	184.3	34.3
STMT60832-8	Cushion Grip Standard 8mm X 200mm	8mm	200	234.3	34.3
STMT60833-8	Cushion Grip Standard 8mm X 250mm	8mm	250	284.3	34.3

CUSHION GRIP™ TORX

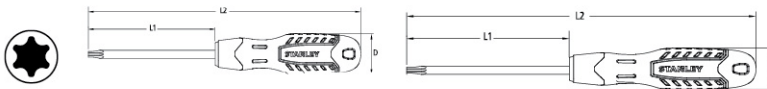

Retail SKU #	Description	Tip size	L1 (mm)	L2 (mm)	D (mm)
STMT60837-8	Cushion Grip Torx T5 X 80mm	T5	80	96.5	16.5
STMT60838-8	Cushion Grip Torx T6 X 80mm	T6	80	96.5	16.5
STMT60839-8	Cushion Grip Torx T7 X 80mm	T7	80	96.5	16.5
STMT60841-8	Cushion Grip Torx T8 X 80mm	T8	80	96.5	16.5
STMT60844-8	Cushion Grip Torx T10 X 80mm	T10	80	96.5	16.5
STMT60845-8	Cushion Grip Torx T15 X 80mm	T15	80	109.5	29.5
STMT60847-8	Cushion Grip Torx T20 X 120mm	T20	120	149.5	29.5
STMT60848-8	Cushion Grip Torx T25 X 120mm	T25	120	152.2	32.2
STMT60849-8	Cushion Grip Torx T27 X 120mm	T27	120	152.2	32.2
STMT60850-8	Cushion Grip Torx T30 X 120mm	T30	120	152.2	32.2
STMT60851-8	Cushion Grip Torx T40 X 120mm	T40	120	154.3	34.3

SLOTTED SCREWDRIVERS



- Improved ergonomic design for maximum grip & torque
- Chrome vanadium blade with tough hardened black oxide
- Nickle plated bar for corrosion resistance
- High quality, heat treated plated bars for lasting "pro" performance & rust resistance

PART No.	DESCRIPTION	SIZE	PBQ
62-241	Screwdriver Slotted	3 X 50mm	10
62-242	Screwdriver Slotted	3 X 75mm	10
62-243	Screwdriver Slotted	3 X 100mm	10
62-244	Screwdriver Slotted	3 X 150mm	10
62-245	Screwdriver Slotted	4 X 75mm	10
62-246	Screwdriver Slotted	4 X 150mm	10
62-247	Screwdriver Slotted	6 X 100mm	10
62-248	Screwdriver Slotted	6 X 150mm	10
62-249	Screwdriver Slotted	6 X 200mm	10
62-250	Screwdriver Slotted	6 X 250mm	10
62-251	Screwdriver Slotted	6 X 300mm	10
62-252	Screwdriver Slotted	8 X 150mm	10
62-253	Screwdriver Slotted	8 X 200mm	10
62-254	Screwdriver Slotted	8 X 250mm	10
62-255	Screwdriver Slotted	8 X 300mm	10

Phillips® SCREWDRIVERS



- Improved ergonomic design for maximum grip & torque
- Chrome vanadium blade with tough hardened black oxide
- Nickle plated bar for corrosion resistance
- High quality, heat treated plated bars for lasting "pro" performance & rust resistance

PART No.	DESCRIPTION	SIZE	PBQ
62-256	Screwdriver Phillips	#0 X 50mm	10
62-257	Screwdriver Phillips	#0 X 100mm	10
62-258	Screwdriver Phillips	#0 X 150mm	10
62-259	Screwdriver Phillips	#1 X 100mm	10
62-260	Screwdriver Phillips	#1 X 150mm	10
62-261	Screwdriver Phillips	#1 X 200mm	10
62-262	Screwdriver Phillips	#2 X 100mm	10
62-263	Screwdriver Phillips	#2 X 150mm	10
62-264	Screwdriver Phillips	#2 X 200mm	10
62-265	Screwdriver Phillips	#2 X 250mm	10
62-266	Screwdriver Phillips	#2 X 300mm	10
62-267	Screwdriver Phillips	#3 X 150mm	10
62-268	Screwdriver Phillips	#3 X 200mm	10
62-269	Screwdriver Phillips	#3 X 250mm	10
62-270	Screwdriver Phillips	#3 X 300mm	10



BASIC LINESMAN PLIERS

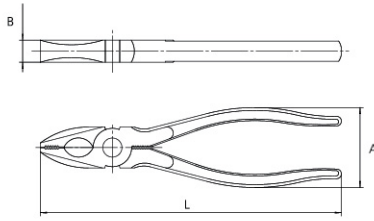

- Forged carbon steel jaws fully heat treated for optimum performance and durability
- Double dipped handle allows comfortable grip
- Drop-forged steel is strong and durable
- Meets ANSI specifications

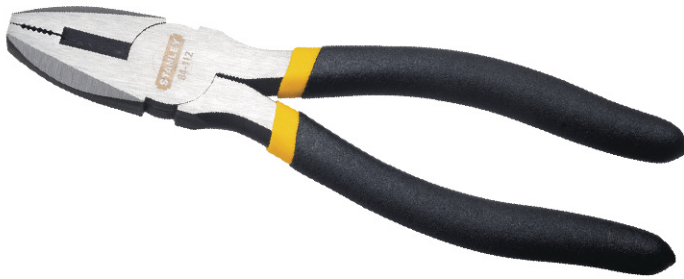

SKU #	Description	A (mm)	B (mm)	L (mm)	Box Qty
STHT84112-8	7" Linesman Pliers	50	12.5	188	6
STHT84113-8	8" Linesman Pliers	50	12.8	218	6

BASIC DIAGONAL CUTTING PLIERS

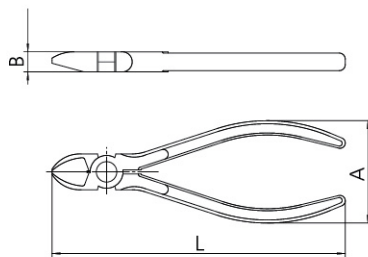

- Forged carbon steel jaws fully heat treated for optimum performance and durability
- Double dipped handle allows for a comfortable grip
- Drop-forged steel is strong and durable
- Meets ANSI specifications



SKU #	Description	A (mm)	B (mm)	L (mm)	Box Qty
STHT84105-8	6" Diagonal Cutting Pliers	50	10.5	154.5	6
STHT84108-8	7" Diagonal Cutting Pliers	50	11.5	180	6

DYNAGRIP™ BENT NOSE PLIERS

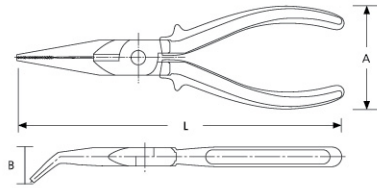

- Forged carbon steel jaws fully heat treated for optimum performance and durability
- Induction hardened cutting edges for greater reliability in cutting
- Bi-material soft grip handle provides excellent comfort
- Ergonomically designed DYNAGRIP™ handle with finger guards for better efficiency and handling



SKU #	Description	A (mm)	B (mm)	L (mm)	Box Qty
STHT84072-8	8" Bent Nose Pliers	11.5	51	200	6

DYNAGRIP™ END NIPPER PLIERS

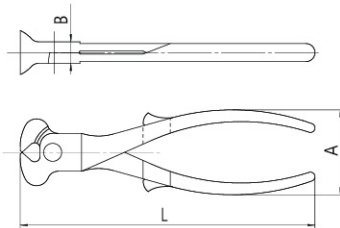

- Forged carbon steel jaws fully heat treated for optimum performance and durability
- Induction hardened cutting edges for greater reliability in cutting
- Bi-material soft grip handle provides excellent comfort
- Ergonomically designed DYNAGRIP™ handle with finger guards for better efficiency and handling



SKU #	Description	A (mm)	B (mm)	L (mm)	Box Qty
STHT84077-8	6" End Nipper Pliers	52	11.9	163	6
STHT84167-8	8" End Nipper Pliers	50	11	202	6

DYNAGRIP™ GROOVE JOINT PLIERS



- Forged carbon steel jaws fully heat treated for optimum performance and durability
- Bi-material soft grip handle provides excellent comfort
- Ergonomically designed DYNAGRIP™ handle with finger guards for better efficiency and handling



SKU #	Description	A (mm)	B (mm)	L (mm)	Box Qty
STHT84024-8	10" Groove Joint Pliers	65.5	10.3	257.7	6

BASIC CIRCLIP PLIERS

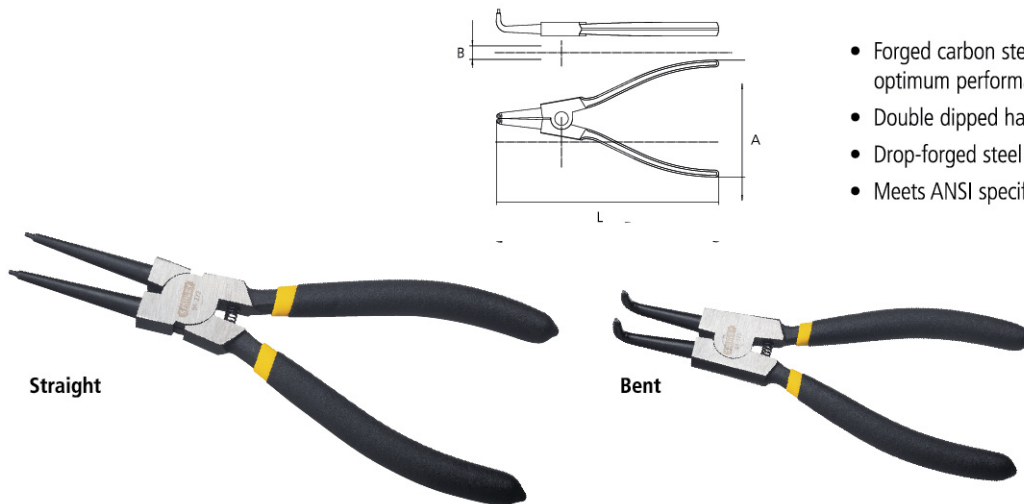

- Forged carbon steel jaws fully heat treated for optimum performance and durability
- Double dipped handle allows comfortable grip
- Drop-forged steel is strong and durable
- Meets ANSI specifications



SKU #	Description	A (mm)	B (mm)	L (mm)	Box Qty
STHT84271-8	7" Circlip Plier Straight Exterior Type	86	10	174	6
STHT84272-8	7" Circlip Plier Bent Exterior Type	86	10	163	12
STHT84273-8	7" Circlip Plier Straight Interior Type	49	9	179	6
STHT84274-8	7" Circlip Plier Bent Interior Type	49	9	169	12

CURVED JAW LOCKING PLIERS



- Chrome plating provides corrosion resistance
- Forged and machined jaws for maximum durability
- Screws adjust the jaws and the clamping pressure amount for precision
- Safety and ease when opening



SKU #	Description	A (mm)	B (mm)	L (mm)	Box Qty
STHT84368-8	7" Curved Jaw Locking Pliers	56	56	175	6
STHT84369-8	10" Curved Jaw Locking Pliers	66	66	254	6

DYNAGRIP™ LONG NOSE PRO LOCKING PLIERS

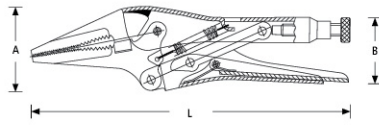

- Ergonomically designed DYNAGRIP™ handle with finger guards for better efficiency and handling
- Forged and machined jaws for maximum durability
- Screws adjust the jaws and the clamping pressure amount for precision
- Safety and ease when opening



SKU #	Description	A (mm)	B (mm)	L (mm)	Box Qty
STHT84389-8	9-1/2" Long Nose Pro Locking Pliers	50.8	47.8	228	6

C CLAMPS LOCKING PLIERS

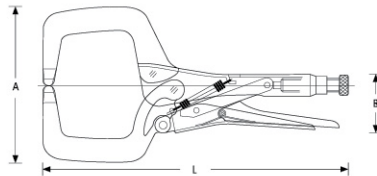

- Chrome plating provides corrosion resistance
- Forged and machined jaws for maximum durability
- Screws adjust the jaws and the clamping pressure amount for precision
- Safety and ease when opening



SKU #	Description	A (mm)	B (mm)	L (mm)	Box Qty
STHT84399-8	11" C Clamps Locking Pliers	138	47.2	279	6

Digital Tire Pressure Gauge

FEATURES:

- 🌀 Easy to Read Digital Display.
- 🌀 Comfort Grip Handle.
- 🌀 Automotive Chemical Resistant Materials.
- 🌀 Integrated LED for Use at Night or Dark Areas.
- 🌀 0.5 PSI Resolution.
- 🌀 Batteries Included.

SKU	Description
STHT-80874-0	Tire Pressure Gauge



Oil Drainer

FEATURES:

- 🌀 Capacity 8 liters.
- 🌀 Impact and hydrocarbon-resistant.
- 🌀 To be used for floor oil change.

SKU	Description
STHT80878-1	Oil Drainer



Self Gripping Oil Filter Wrench

FEATURES:

- 🌀 For oil filters.
- 🌀 3/8" drive bit.
- 🌀 Ø : 65-120 mm.

Grip and anti slip jaws.
More grip on the filter, more power.
Fits with 3 in 1 Stanley tool.

SKU	Description
STHT80880-0	Oil Filter Wrench



Telescopic Wheel Tool

FEATURES:

- 🌀 Telescopic handle to unscrew wheel bolts.
 - 🌀 Telescopic handle to more torque.
 - 🌀 2 sockets: 17/19 mm, 21/23 mm.
- Stanley specific handle.
Better grip and more power.

SKU	Description
STHT80890-0	Telescopic Tool



27 pc 1/2" Square Drive Socket Set

86-477



86-477

27 Piece Socket Set -
1/2" Drive

20pc 1/2" dr 12pt sockets:
10, 11, 12, 13, 14, 15, 16, 17, 18, 19, 20, 21, 22,
23, 24, 25, 26, 27, 30, 32mm.
6pc 1/2" dr accessories: 2 Extension bar: 5" & 10", 1
Universal joint, 1 Spark plug socket 6pt 13/16",
1 Sliding t-Bar 10", 1 Filp-drive ratchet.

110 pc Multi Tool Set

STMT81243-840

The Stanley Multi-Tool Kit is ideal for consumers looking for practical and complete solutions for everyday use. With 110 pieces for the most varied solutions, be it mechanical, electric, hydraulic and others, this tool kit contains a personalized plastic case, with identification of all tools and measures, facilitating storage and avoiding possible losses.



Contains: 5 Screwdrivers
Diagonal Cutting Pliers 6 "
Pliers half-reed 8 "
Water Pump Pliers 10 "
Screwdrivers: 5.5x75mm, 6.5x100mm
Cross Slit Wrenches: n°1x75mm, n°2x100mm
Combination wrenches: 8, 9, 10, 11, 12, 13, 14, 15, 17, 18, 19 mm
Hexagon wrenches: 1,5, 2, 2,5, 3, 4, 5, 5,5, 6 mm
Sockets and Accessories 1/2 "
Sockets: 10, 11, 12, 13, 14, 15, 17, 18, 19, 20, 21, 22, 23, 24, 27 mm
Socket of candle: 16, 21 mm
Ratchet and extension 5 "
Universal joint and T 10 "
Sockets and accessories 1/4 ": Sockets: 4, 5, 6, 7, 8, 9, 10, 11, 12, 13, 14 mm
Ratchet and extension 2 "
Flexible extension 6 "
Universal joint 6 "
Bits split points: 2 x 3.5, 2 x 4, 5.5, 6.5, 8 mm
Square point bits: S1, S2, S3
Cross bits split bits: 2 x n°0, 2 x n°1, 2 x n°2, 2 x n°3, 2 x adapter
Hexalobular tips bits: T10, T15, T20, T25, T27, T30, T40
Pozi Drive Bit Tips: PZ1, PZ2, PZ3
Tri-Wing Bit Tips: 1, 2, 3, 4
Bits hexagonal tips: 2, 3, 4, 5, 6, 7
Thermoplastic case

72 pc 1/2" Square Drive Socket Set

1-94-660

1/4" & 1/2" Sq Dr MicroTough ratchets / 1 1/4" Sq
Dr spinner handle / 75 mm 1/4" Sq Dr. extension
bar / 75& 125 mm 1/2" Sq Dr. extension bars / 1 125 mm
1/4" Sq Dr. Sliding T bar / 1 250 mm 1/2" Sq
Dr. Sliding T bar / 1/4" & 1/2" Sq Dr. Universal joint

FEATURES & BENEFITS

5° angle of engagement
Comfortable bi material handle
Fine tooth 72-tooth gear
Full colour, customer friendly illustrated sleeve
Full ISO spec
Patented innovation for Stanley®
Thumb operated reverse switch



SKU #	Number of pieces
1-94-660	72

STANLEY®

AUTHORIZED DISTRIBUTOR

All rights reserved. Neither this catalogue, nor its text, illustrations, drawings or any part thereof, may be reproduced, stored in a retrieval system, photocopied, recorded or transmitted in any form, whether electronic or otherwise, without Stanley Black & Decker's consent. To the best of Stanley Black & Decker's knowledge all descriptions, illustrations and prices contained in this catalogue are correct at the time of going to print. Stanley Black & Decker's cannot however, be held liable for any inaccuracies of description or illustration and reserve the right to change prices without notification.

Orders are subject to minimum box quantities. We reserve the right to amend specifications without prior notice. ©Stanley Works 2019

E-mail: mea@stanleyworks.com
Website: www.stanleytools.ae